

ENCHANT 900



OWNER'S MANUAL

IMPORTANT SAFETY INSTRUCTIONS

Verify Line Voltage Before Use

The ENCHANT soundbar has been designed for use with 100-240 volt, 50/60 Hz AC current. Connection to a line voltage other than that for which your product is intended can create a safety and fire hazard and may damage the unit. If you have any questions about the voltage requirements for your specific model or about the line voltage in your area, contact your selling dealer before plugging the unit in to a wall outlet.

Do Not Use Extension Cables

To avoid safety hazards, use only the power cable supplied with your unit. We do not recommend that extension cables be used with this product. As with all electrical devices, do not run power cables under rugs or carpets, or place heavy objects on them. Damaged power cables should be replaced immediately by an authorized service center with a cable that meets factory specifications.

Handle the AC Power Cable Gently

When disconnecting the power cable from an AC outlet, always pull the plug; never pull the cable.

If you do not intend to use your soundbar for any considerable length of time, disconnect the plug from the AC outlet.

Do Not Open the Cabinet

There are no user-serviceable components inside this product. Opening the cabinet may present a shock hazard, and any modification to the product will void your warranty. If water accidentally falls inside the unit, disconnect it from the AC power source immediately, and consult an authorized service center.

TABLE OF CONTENTS

IMPORTANT SAFETY INSTRUCTIONS	2
1 INTRODUCTION.....	5
2 WHAT'S IN THE BOX.....	7
3 PRODUCT OVERVIEW.....	8
3.1 Front panel & Top panel.....	8
3.2 Back panel.....	10
3.3 Remote control.....	11
4 PLACE.....	13
4.1 Desktop placement.....	13
4.2 Wall-mounting.....	14
5 CONNECT.....	16
5.1 Connect with your TV and digital devices.....	16
5.2 Connect to your Bluetooth device.....	20
5.3 Connect to your home network.....	22
6 SETUP.....	25
6.1 Connect power.....	25
6.2 3D surround sound.....	26
7 PLAY.....	31
7.1 Switch on.....	31
7.2 Play from the TV source.....	32
7.3 Play from the HDMI IN source.....	34
7.4 Play from the Bluetooth source.....	35
7.5 Play over your home network.....	36

8	SOUND SETTINGS.....	42
8.1	Audio sync mode.....	42
8.2	Smart mode.....	42
9	GROUPING (OPTIONAL)	43
10	RESTORE FACTORY SETTINGS.....	44
11	SOFTWARE UPDATE.....	45
12	PRODUCT SPECIFICATIONS	46
13	TROUBLESHOOTING.....	48
14	TRADEMARKS.....	52
15	OPEN SOURCE LICENSE NOTICE.....	53

1 INTRODUCTION

This manual includes information of the Harman Kardon ENCHANT 900 (soundbar). We encourage you to take a few minutes to read this manual, which describes the product and includes step-by-step instructions to help you set up and get started. Read and understand all the safety instructions before using your product.

This product may have an important software update available. Please follow the instructions to connect the product to Wi-Fi to ensure that your product has the most recent software updates.

Design and specifications are subject to change without notice. Some features require subscriptions or services not available in all countries.

If you have any questions about this product, its installation or its operation, please contact your Harman Kardon retailer or customer service, or visit us at www.harmankardon.com.

Harman Kardon One app

With the Harman Kardon One app, you can

- easily connect the soundbar to your Wi-Fi network;
- access software updates when they are available;
- connect *music streaming services;
- launch audio calibration;
- personalize audio settings;
- access additional features.

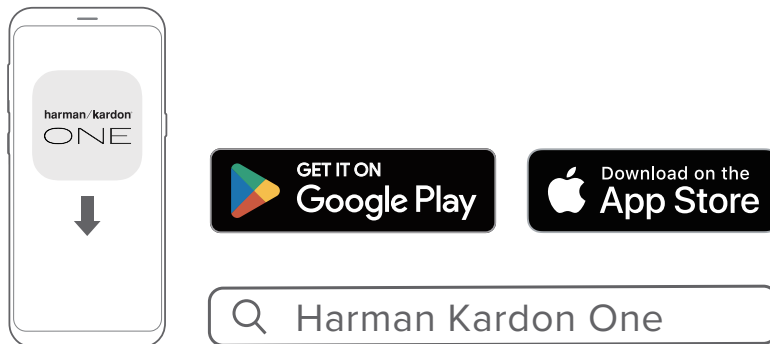

For more information, see [“5.3 Connect to your home network”](#) and [“7.5 Play over your home network”](#).

NOTES:

- *Subscription may be needed and not provided by the Harman Kardon One app.
- App screens may vary due to software updates. Always follow the app instructions.

2 WHAT'S IN THE BOX

Unpack the box carefully and ensure that the following parts are included. If any part is damaged or missing, do not use it and contact your retailer or customer service representative.

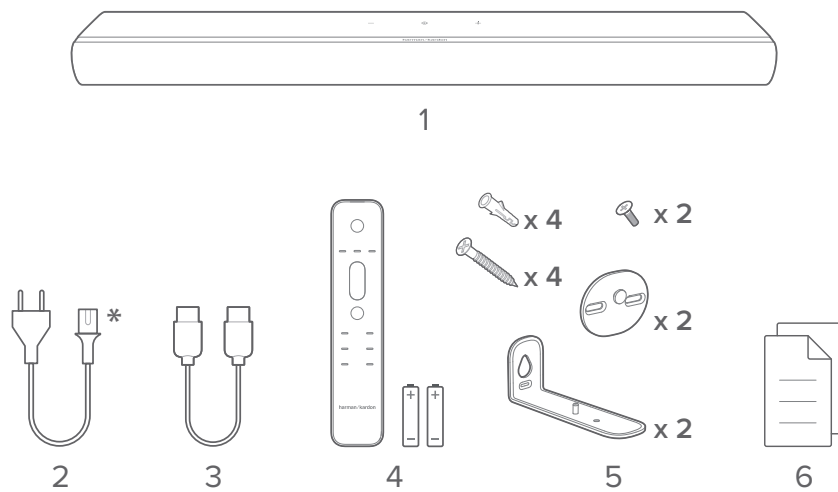

1. Soundbar
2. Power cable*
3. HDMI cable (1.2 m / 3.9 ft)
4. Remote control (with 2 AAA batteries)
5. Wall-mounting kit
6. Product information & wall-mounting template

*Power cable quantity and plug type vary by regions.

3

PRODUCT OVERVIEW

3.1 Front panel & Top panel

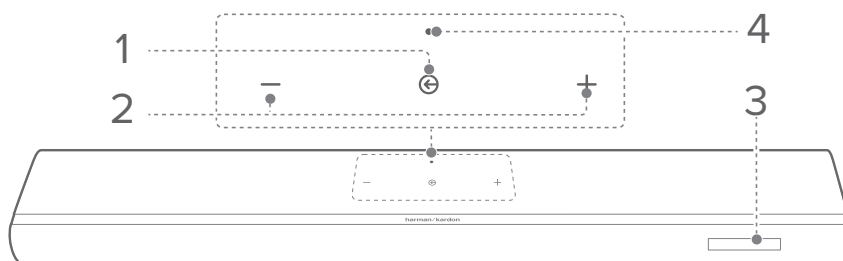

1. (Source)







- Switch on.
- Select a sound source: TV (default, for audio input from TV connection where the **HDMI OUT (TV eARC/ARC)** connector is prioritized over the **OPTICAL** connector), Bluetooth or HDMI IN.
- Hold for more than 3 seconds to enter Bluetooth pairing mode.

2. (Volume)

- Press to decrease or increase the volume.
- Press together to mute or unmute.
- Hold to decrease or increase the volume continuously.
- Hold together for more than 10 seconds to enter Wi-Fi setup mode.

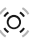
3. Status display

4. Status indicator

System:		
	Regular pulsing (white)	System startup
	Fast pulsing (white)	Software updating in progress
	Solid (amber)	Restoring factory settings
Network connection:		
	Slow pulsing (white)	Entering Wi-Fi setup mode, or network disconnected
	Solid (green)	Soundbar discovered by the Harman Kardon One app
	Solid (white)	Network connected
	Solid (yellow)	Weak Wi-Fi connection

3.2 Back panel

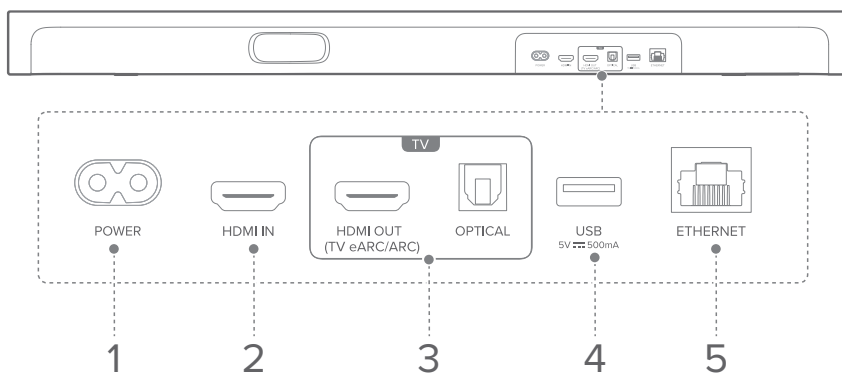

1. POWER

- Connect to power (with the supplied power cord).

2. HDMI IN

- Connect to the HDMI output on your digital device.

3. TV connectors

HDMI OUT (TV eARC/ARC)

- Connect to the HDMI eARC/ARC input on your TV.

OPTICAL

- Connect to an optical audio output on your TV or a digital device.

4. USB

- USB connector for software update (for service only).
- Connect to USB storage device for MP3 file playback (for US version only).

5. ETHERNET

- Connect to your home network through an Ethernet cable.

3.3 Remote control

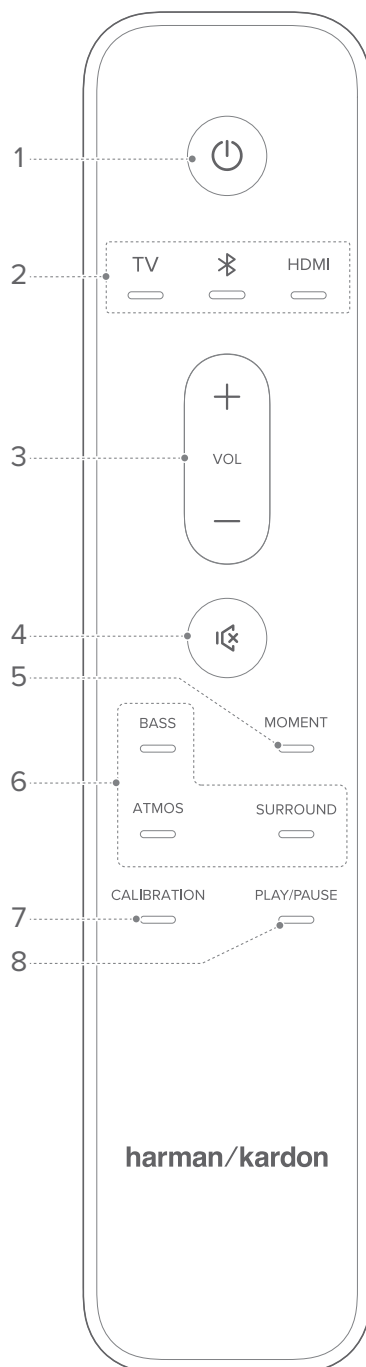

1. ⏻ (Power)

- Switch on or to standby.

2. Source selectors

TV

- Select the TV source (default, for audio input from TV connection where the **HDMI OUT (TV eARC/ ARC)** connector is prioritized over the **OPTICAL** connector).

📶 (Bluetooth)

- Press to select the Bluetooth source.
- Hold for more than 3 seconds to pair with a new device.

HDMI

- Select the **HDMI IN** source.

3. VOL + / -

- Press to increase or decrease the volume.
- Hold to increase or decrease the volume continuously.

4. 🔇

- Mute or unmute.

5. MOMENT

- Press to directly access your music playlist and soundbar settings that you have personalized in the Harman Kardon One app.

6. Sound effect buttons

BASS

- Adjust the bass level of the soundbar or subwoofer (if connected).

ATMOS

- Select the level of Dolby Atmos® effect: middle (default), high or low.

SURROUND

- Soundbar only: Enable or disable Smart mode.
- With optional Enchant speakers: Adjust the level of the rear surround speakers.

7. CALIBRATION

- Press to start sound calibration.

8. PLAY/PAUSE

(Playback controls during Wi-Fi / Bluetooth music streaming)

- Single press: Pause or resume playback
- Double press: Next track
- Triple press: Previous track

NOTE:

- Not all Wi-Fi music services support PLAY/PAUSE controls.

4 PLACE

4.1 Desktop placement

Place the soundbar on a flat and stable surface.

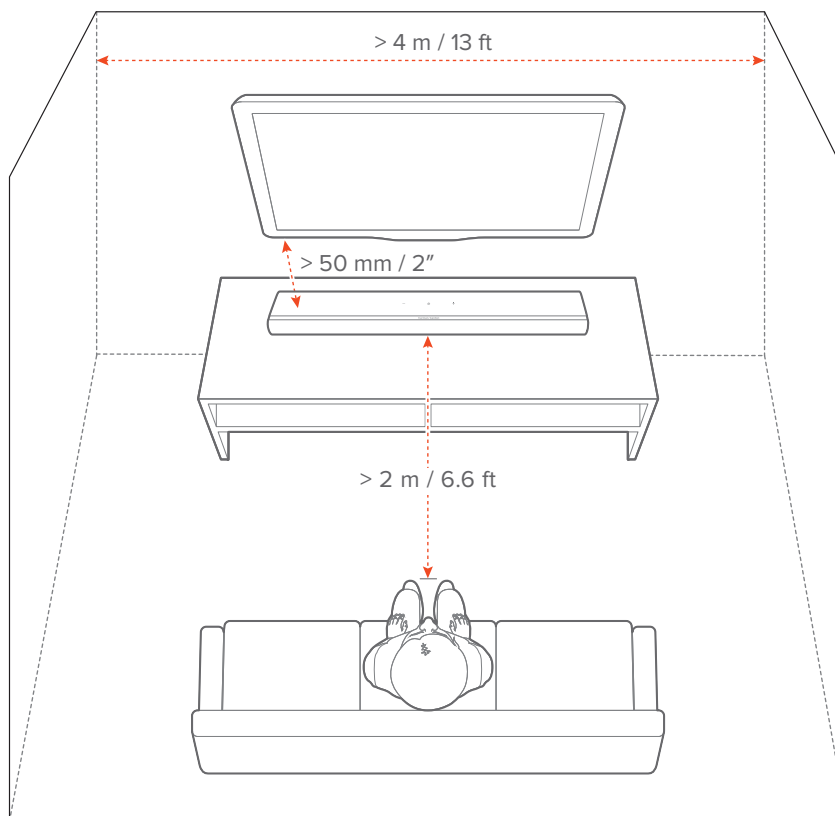

NOTES:

- The power cable shall be properly connected to power.
- Do not place any objects on the top of the soundbar.

4.2 Wall-mounting

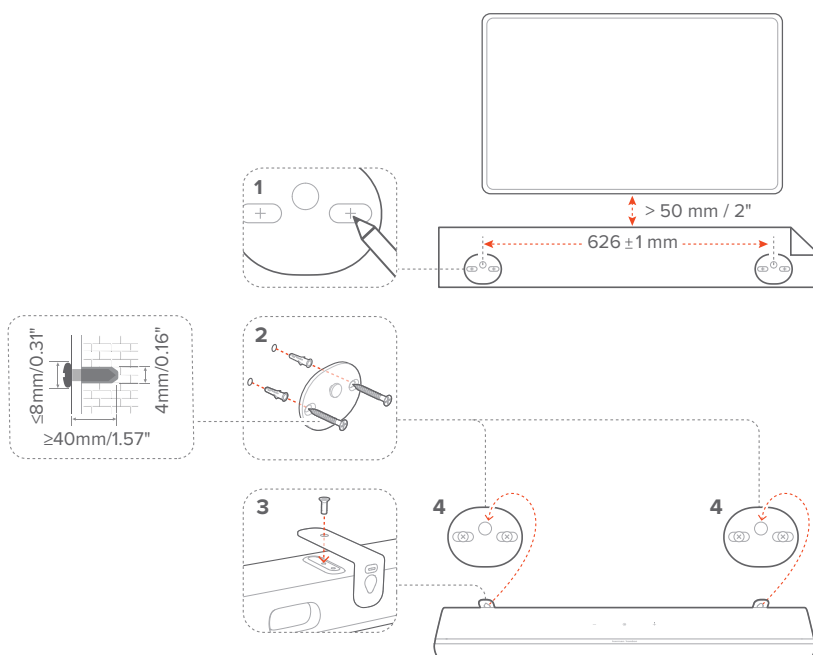

- 1) Preparation:
 - a) With a minimum distance of 50 mm / 2" from your TV, stick the supplied wall-mounting template to a wall by using adhesive tapes.
 - b) Use your ballpen tip to mark the location of the screw holder. Remove the template.
 - c) On the marked location, drill a 4 mm / 0.16" hole.
- 2) Install the support for wall-mounting bracket.
- 3) Use the screw to secure the wall-mounting bracket onto the bottom of the soundbar.
- 4) Mount the soundbar.

NOTES:

- Make sure that the wall can support the weight of the soundbar.
- Install on a vertical wall only.
- Avoid a location under high temperature or humidity.
- Before wall-mounting, make sure that the cables between the soundbar and any external devices are properly connected.
- Make sure that the soundbar is unplugged from the wall outlet before wall-mounting. Failure to do so may result in electric shock.

5 CONNECT

5.1 Connect with your TV and digital devices

To play audio through the soundbar, connect the soundbar to your TV using the supplied HDMI cable or an optical cable (sold separately).

An HDMI connection supports digital audio and video with a single connection. HDMI connectivity is the best option for your soundbar.

NOTES:

- *The HDMI cable (for digital device connection) and the optical cable are sold separately.
- Full compatibility with all HDMI-CEC devices is not guaranteed.
- When both HDMI eARC/ARC and optical cables are connected to the soundbar for audio input from TV connection, the HDMI eARC/ARC connection is prioritized.

5.1.1 HDMI eARC

(Recommended connection for the best Dolby Atmos experience)

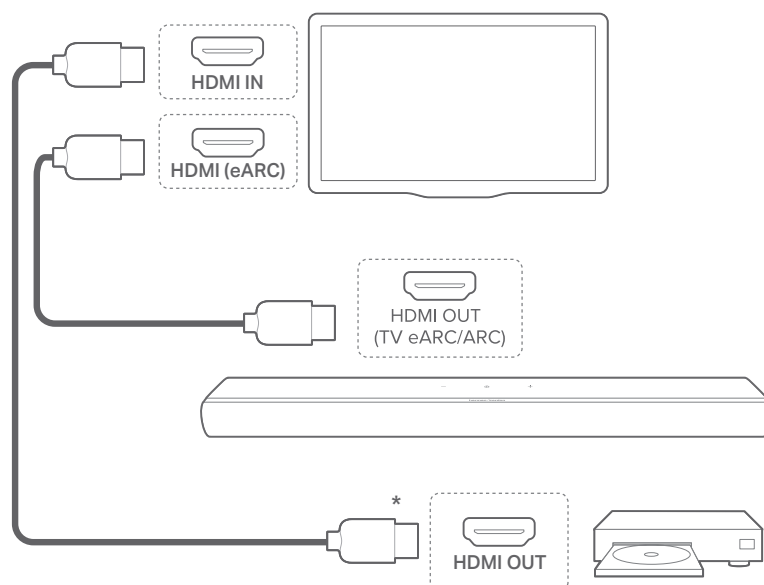

- 1) Connect the soundbar with the **HDMI (eARC)** connector on your TV by using the supplied HDMI cable.
 - On your TV, check that HDMI-CEC and HDMI eARC have been enabled. Refer to the owner's manual of your TV for more information.
- 2) Use an HDMI cable (V2.0 or later) to connect your TV with your digital device, such as a streaming device, set-top box, DVD / Blu-ray player or game console.
 - On your digital device, check that HDMI-CEC has been enabled. Refer to the owner's manual of your digital device for more information.
 - On your TV and digital device, select "Bitstream" or "Raw data" in the audio output settings for the best Dolby Atmos experience.

NOTE:

- To play audio from the digital device connected to your TV, switch on the soundbar (See "[7.1 Switch on](#)") and select the **TV** source (See "[7.2 Play from the TV source](#)").

5.1.2 HDMI ARC

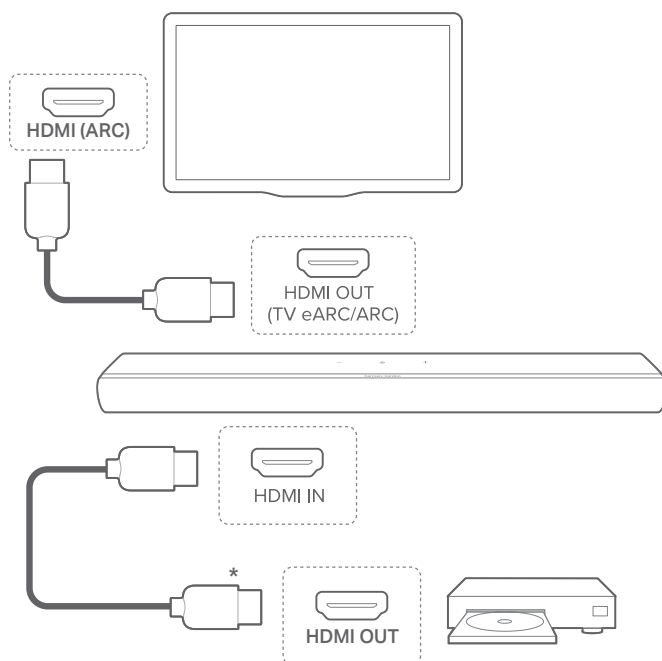

- 1) Connect the soundbar with the **HDMI IN (ARC)** connector on your TV by using the supplied HDMI cable.
 - On your TV, check that HDMI-CEC and HDMI ARC have been enabled. Refer to the owner's manual of your TV for more information.
- 2) Use an HDMI cable (V2.0 or later) to connect the soundbar with your digital device, such as a set-top box, DVD/Blu-ray player or game console.
 - On your digital device, check that HDMI-CEC has been enabled. Refer to the owner's manual of your digital device for more information.
 - On your digital device, select "Bitstream" or "Raw data" in the audio output settings for the best Dolby Atmos experience.

NOTES:

- To play audio from the digital device connected to the soundbar, switch on the soundbar (See [“7.1 Switch on”](#)) and select the **HDMI IN** source (See [“7.3 Play from the HDMI IN source”](#)).
- If your TV does not support HDMI eARC, make sure that you connect your digital device through the **HDMI IN** connector on the soundbar instead of your TV. Otherwise, the Dolby Atmos information cannot pass through the HDMI (eARC/ARC) connectors to the soundbar.

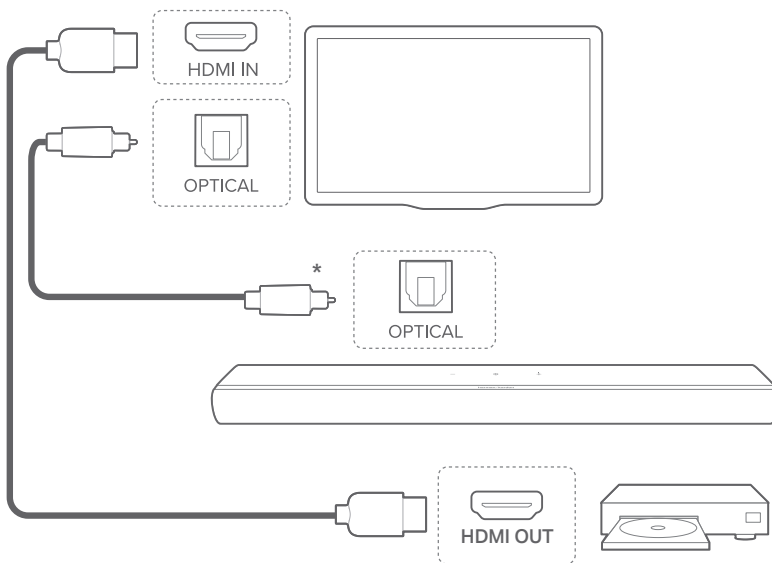
5.1.3 OPTICAL

- 1) Connect the soundbar with your TV by using an optical cable.
- 2) Use an HDMI cable (V2.0 or later) to connect your TV with your digital device, such as a streaming device, set-top box, DVD / Blu-ray player or game console.

NOTE:



- To play audio through the optical cable, switch on the soundbar (See [“7.1 Switch on”](#)) and select the **TV** source (See [“7.2 Play from the TV source”](#)).

5.2 Connect to your Bluetooth device

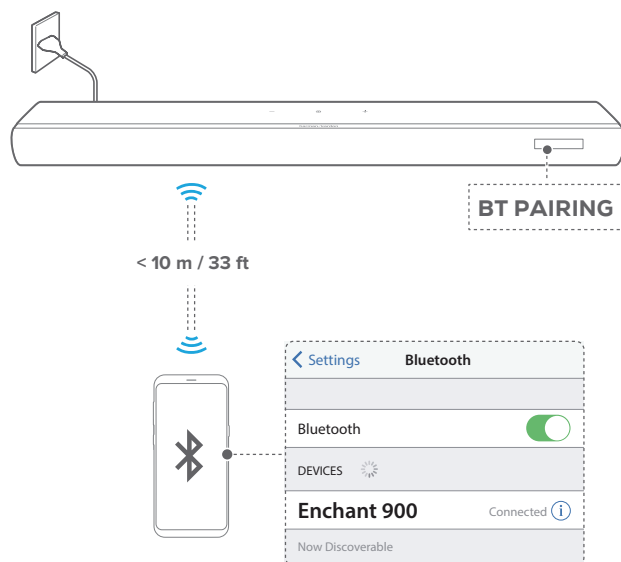
Through Bluetooth, connect the soundbar with your Bluetooth device, such as a smartphone, tablet or laptop.



5.2.1 Connect a Bluetooth device



- 1) Switch on the soundbar (See “[7.1 Switch on](#)”).
- 2) To enter Bluetooth pairing mode, press  on the soundbar or  on the remote control.
→ **“BT PAIRING”**: Ready for Bluetooth pairing.
- 3) On your Bluetooth device, enable Bluetooth and search for **“Enchant 900”** within 3 minutes.
→ **Successful connection**: Your device name or **“BT CONNECTED”** is displayed. A confirmation tone is heard.

5.2.2 To reconnect the last paired device

Your Bluetooth device is retained as a paired device when the soundbar goes to standby mode. Next time you switch to the Bluetooth source, the soundbar reconnects the last paired device automatically.

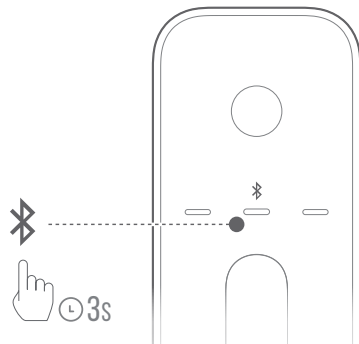
5.2.3 To connect to another Bluetooth device



- 1) In the Bluetooth source, hold  on the soundbar or  on the remote control until **"BT PAIRING"** is displayed.
→ The soundbar enters the Bluetooth pairing mode.
- 2) Follow Step 3 under ["5.2.1 Connect a Bluetooth device"](#).

NOTES:

- The soundbar can connect two Bluetooth devices simultaneously. You can pair with a second Bluetooth device without disconnecting the first one.
- The Bluetooth connection will be lost if the distance between the soundbar and Bluetooth device exceeds 10 m / 33 ft.
- Electronic devices may cause radio interference. Devices that generate electromagnetic waves must be kept away from the soundbar, such as microwaves and wireless LAN devices.

5.3 Connect to your home network

Using Wi-Fi or an Ethernet cable, connect the soundbar to your network. With the Harman Kardon One app and the supported streaming services (Google Cast™, AirPlay, and Spotify Connect), the soundbar allows you to stream audio from smartphones or tablets.

5.3.1 Wi-Fi connection with your home network

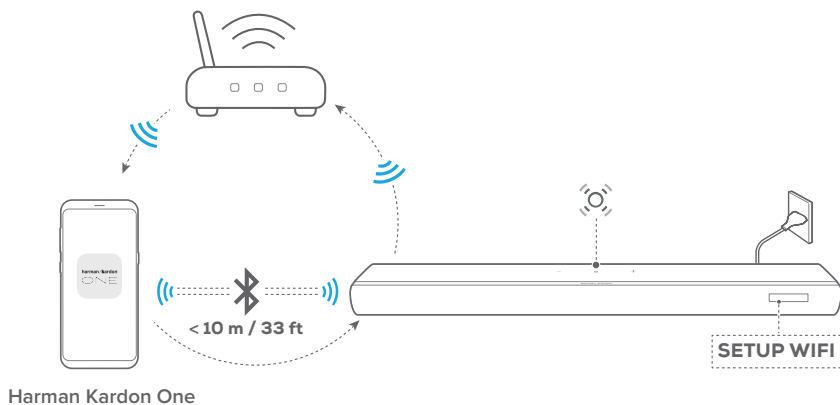

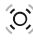
- 1) Switch on the soundbar (See “[7.1 Switch on](#)”).
- 2) On the soundbar, hold **-/+** together for more than 10 seconds to enter the Wi-Fi setup mode.
 - The screen shows “**HELLO**” and then “**SETUP WIFI**”.
 -  (Slow pulsing white): The soundbar enters Wi-Fi setup mode.
- 3) Connect your Android™ or iOS device to your home Wi-Fi network. Download the Harman Kardon One app.

- 4) Launch the Harman Kardon One app. Follow the app instructions to complete Wi-Fi setup.

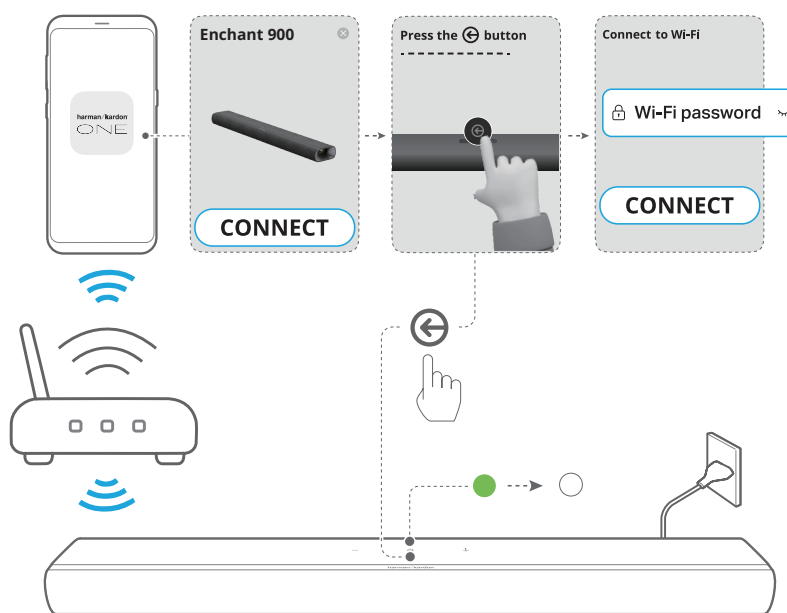

- ● (Solid green): The soundbar is discovered by the Harman Kardon One app.
- ○ (Solid white): The soundbar is connected to your home network.
- You can stream music from the Harman Kardon One app or the streaming services you have enabled in the Harman Kardon One app (See [“7.5 Play over your home network”](#)).

NOTES:

- Make sure that your soundbar is connected to the same Wi-Fi network as your Android or iOS device.
- If your soundbar is not discovered by the Harman Kardon One app, hold **—/+** together for more than 10 seconds to re-enter the Wi-Fi setup mode.

5.3.2 Wired connection with your home network through an Ethernet cable (Optional)

- 1) Use an Ethernet cable (not supplied) to connect the soundbar to your home network.

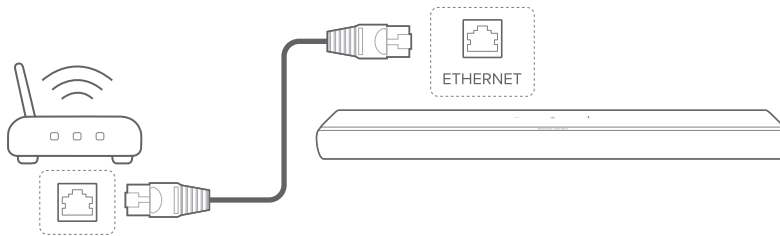

- 2) On your Android or iOS device, download and launch the Harman Kardon One app for music streaming.

NOTES:

- On your Android or iOS device, you can rename the soundbar in the Harman Kardon One app.
- On your iOS device, add the soundbar to the Apple Home app and manage it together with other AirPlay-compatible speakers.
- On your iOS device, if the soundbar has been added to your home Wi-Fi network, you can start AirPlay streaming from an AirPlay-compatible app (See [“7.5.2 Play through AirPlay”](#)).
- Availability of online music streaming services varies by country.
- Some features require subscriptions or services not available in all countries.

6 SETUP

6.1 Connect power

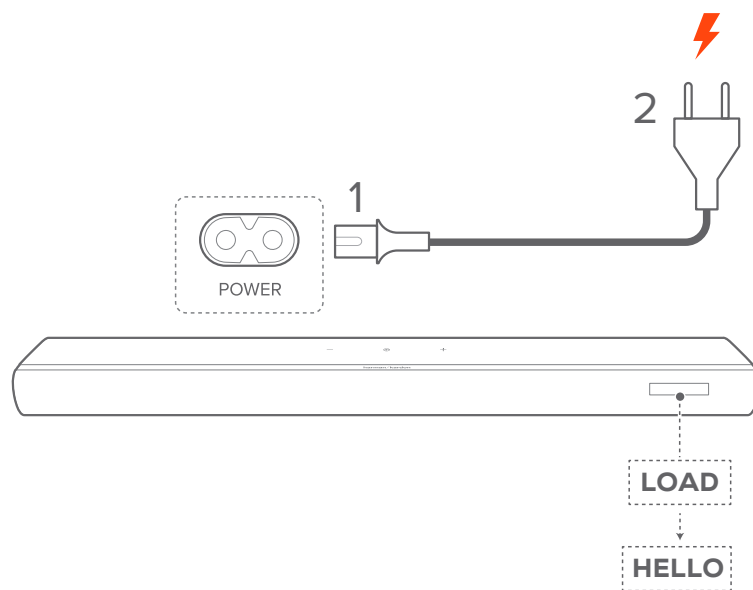

- Connect the soundbar to power by using the supplied power cord.
 - The screen on the soundbar shows “**LOAD**” and then “**HELLO**”.

NOTES:

- Use the supplied power cord only.
- Before connecting to power, make sure that you have completed all other connections (See “[5.1 Connect with your TV and digital devices](#)”).

6.2 3D surround sound

6.2.1 Sound calibration

Optimize your 3D surround sound experience for your unique listening environment.

- 1) On the remote control, press **CALIBRATION** to start calibration.

→ “**CALIBRATION**” is displayed on the soundbar.

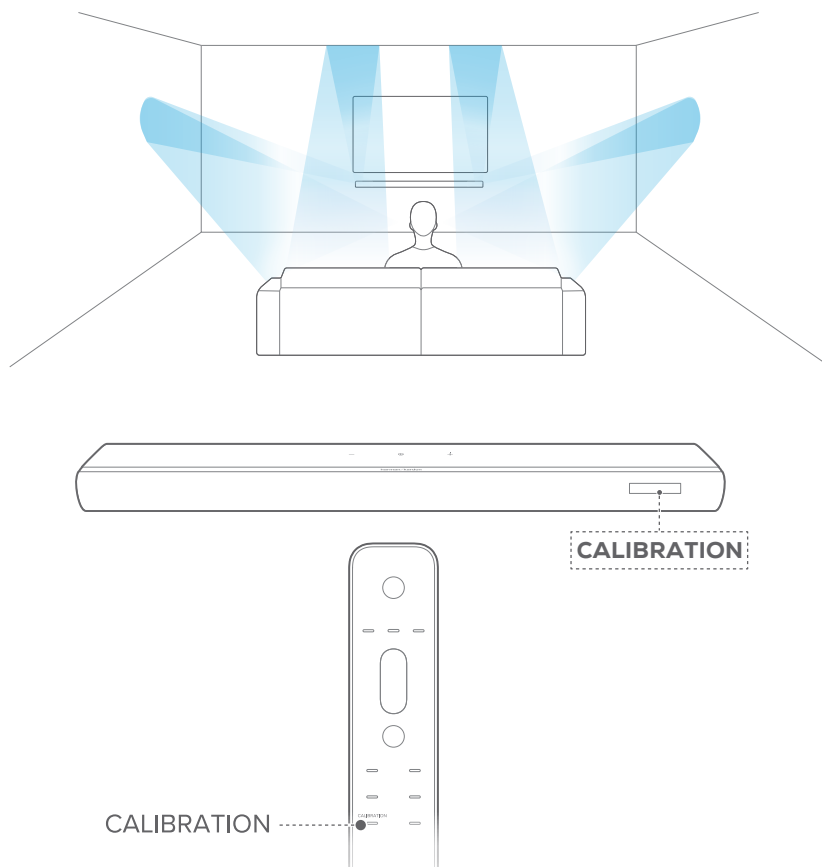

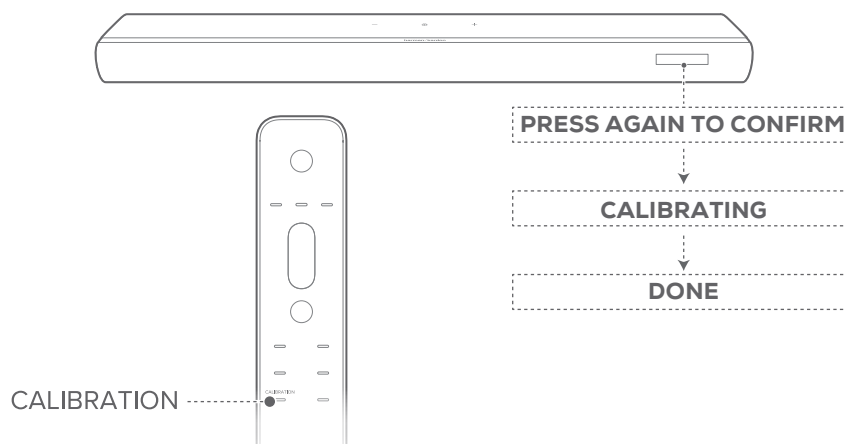

- 2) When “**PRESS AGAIN TO CONFIRM**” is displayed, press **CALIBRATION** again.

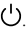

- Countdown starts from 5 to 1.
- Calibration tone is heard. Audio calibration starts.
- “**CALIBRATING**”: Calibration in progress
- “**DONE**”: Calibration completed successfully

NOTES:

- During sound calibration, all buttons on the remote control are disabled except for .
- During sound calibration, environmental sound will be recorded. Hold **CALIBRATION** for 10 seconds, then press  to play the recorded audio (for US version only).

6.2.2 Dolby Atmos

With Dolby Atmos, overhead audio distribution is provided for powerful 3D sound immersion.

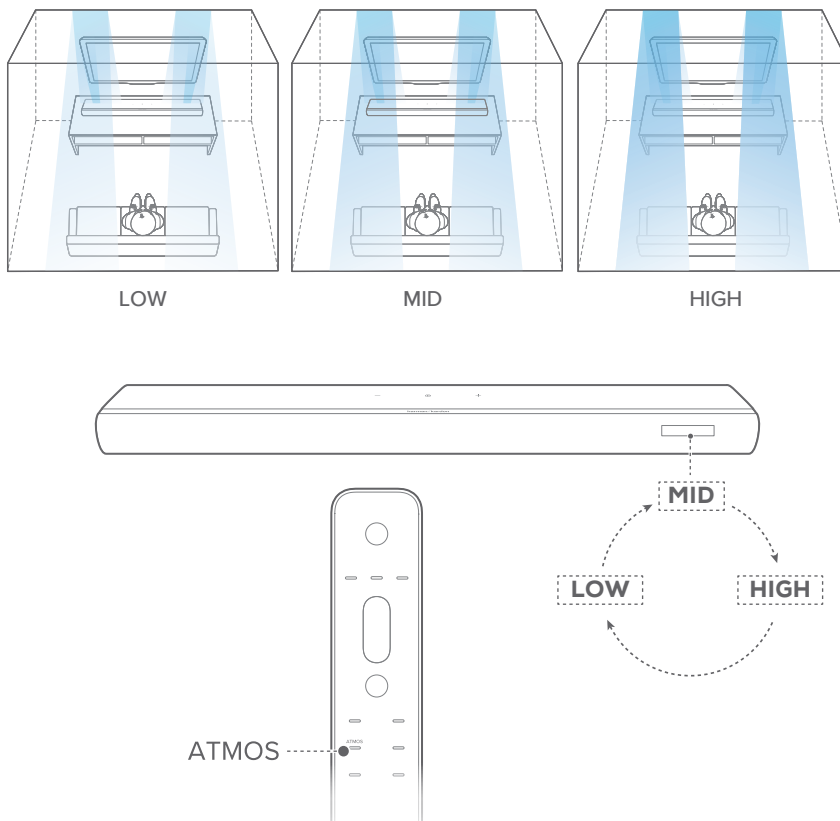

- 1) To play the surround sound of Dolby Atmos, connect and play your Blu-ray player or streaming device as described under [“5.1 Connect with your TV and digital devices”](#).
- 2) To select suitable strength for Dolby Atmos, press **ATMOS** on the remote control to toggle between “**MID**”, “**HIGH**”, or “**LOW**” (Default: “**MID**”).

NOTES:

- The Dolby Atmos sound effects apply only to Dolby audio content.
- With the Dolby Atmos design, the Dolby surround upmixer of the soundbar can expand the legacy channel-based audio of Dolby Digital format, including 5.1 and 7.1 content, and provide an immersive 3D Atmos experience.

6.2.3 Bass adjustment

You can adjust the bass level of the soundbar or subwoofer (if connected).

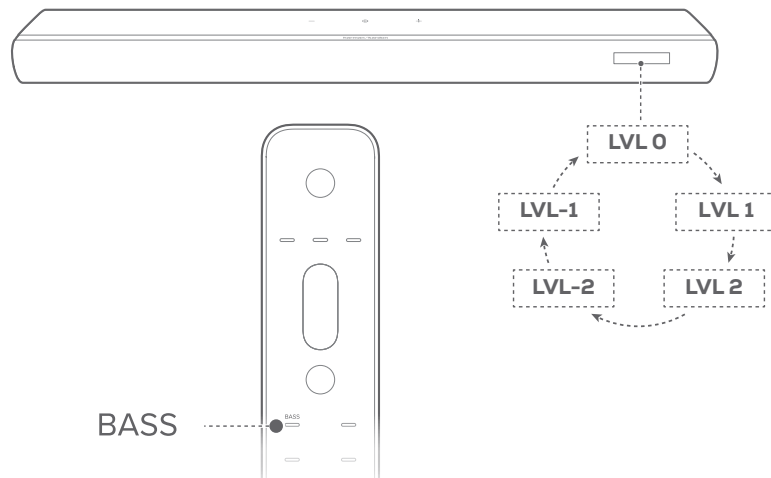

- On the remote control, press **BASS** to toggle between bass levels: “**LVL - 2**”, “**LVL - 1**”, “**LVL 0**”, “**LVL 1**”, or “**LVL 2**” (Default: “**LVL 0**”).

6.2.4 Rear adjustment

If rear speakers (sold separately) are connected, you can select the surround sound level.

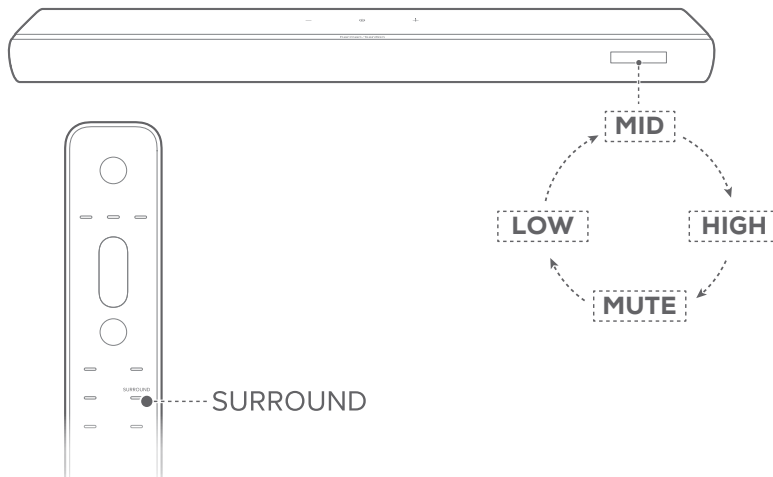

- On the remote control, press **SURROUND** to toggle between surround sound levels.
→ “MID” / “HIGH” / “MUTE” / “LOW” is displayed (Default: “MID”).

7 PLAY

7.1 Switch on

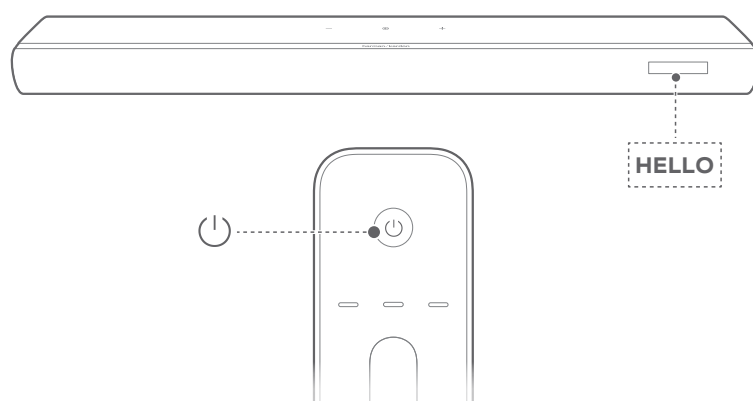

To switch on, press any button on the soundbar, or  on the remote control.

→ “HELLO” is displayed.

7.1.1 Auto standby

If the soundbar is inactive for more than 10 minutes, it will switch to standby mode automatically.

→ “STDBY” is displayed.

→ Next time you switch on the soundbar, it returns to the last selected source.

7.1.2 Auto wakeup

In standby mode, the soundbar will wake up automatically when

- the soundbar is connected to your TV through the HDMI eARC/ARC connection and your TV is switched on;
- the soundbar is connected to your TV and digital device such as a set-top box, DVD/Blu-ray player or game console through HDMI cables, and your digital device is switched on;
- the soundbar is connected to your home network and audio is streamed to the soundbar through the music streaming services.

7.2 Play from the TV source

With the soundbar connected, you can enjoy TV audio from the soundbar.

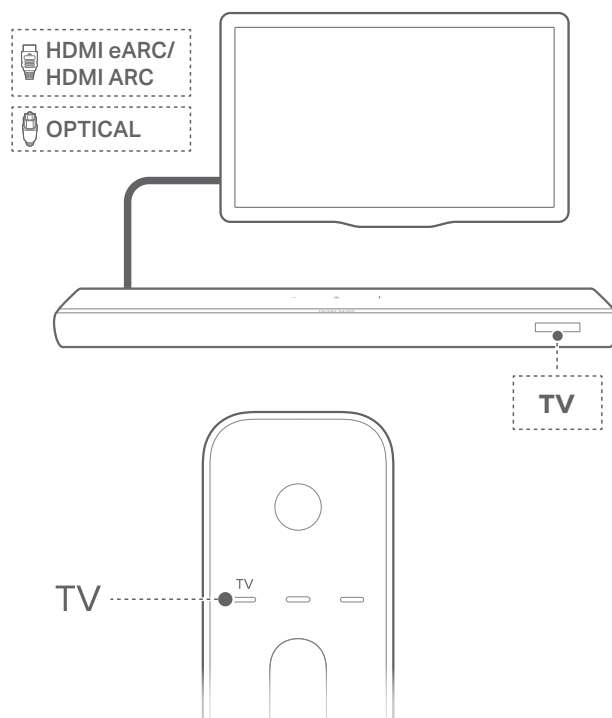

- 1) Make sure that your TV is set to support external soundbars and the built-in TV soundbars are muted. Refer to the owner's manual of your TV for more information.
- 2) Make sure that the soundbar has been properly connected to your TV (See [“5.1 Connect with your TV and digital devices”](#)).
- 3) To select the TV source, press **Ⓢ** on the soundbar or **TV** on the remote control.
 - ➔ **“TV”**: The TV source is selected.
 - In the factory settings, the TV source is selected by default.

NOTE:

- If the soundbar is connected to your TV using both an HDMI cable and an optical cable, the HDMI cable source will be selected for the TV connection.

7.2.1 TV remote control setup

To use your TV remote control for both your TV and the soundbar, check that your TV supports HDMI-CEC. If your TV does not support HDMI-CEC, follow the steps under [“TV remote control IR learning”](#).

HDMI-CEC

If your TV supports HDMI-CEC, enable the functions as instructed in your TV user manual. You can control the “volume +/-, mute/unmute, and power on/standby” functions on the soundbar with your TV remote control.

TV remote control IR learning

Through IR learning, you can program the soundbar to accept IR commands from your TV remote control, and then use your TV remote control for simple commands.

- 1) On the soundbar, hold **⊕** and **+** until **“LEARNING”** is displayed.
 - The soundbar enters the TV remote control learning mode.
- 2) Point your TV remote control at the soundbar. Follow the screen instructions to operate the buttons on your TV remote control:
 - When any one of **“POWER”**, **“VOL+”**, **“VOL-”**, or **“MUTE”** is displayed on the soundbar, press the desired button on your TV remote control.
 - **“DONE”**: These commands are learned by the soundbar.
 - The soundbar returns to the last selected source.

- To exit the TV remote control learning mode, hold **⏻** and **+** on the soundbar until **“EXIT LEARNING”** is displayed.
→ The learnt functions are discarded.

NOTE:

- The soundbar will automatically exit the TV remote control learning mode if no action is taken for 30 seconds. The learnt functions are discarded.

7.3 Play from the HDMI IN source

With the soundbar connected as shown, your digital device can play video on your TV and audio from the soundbar.

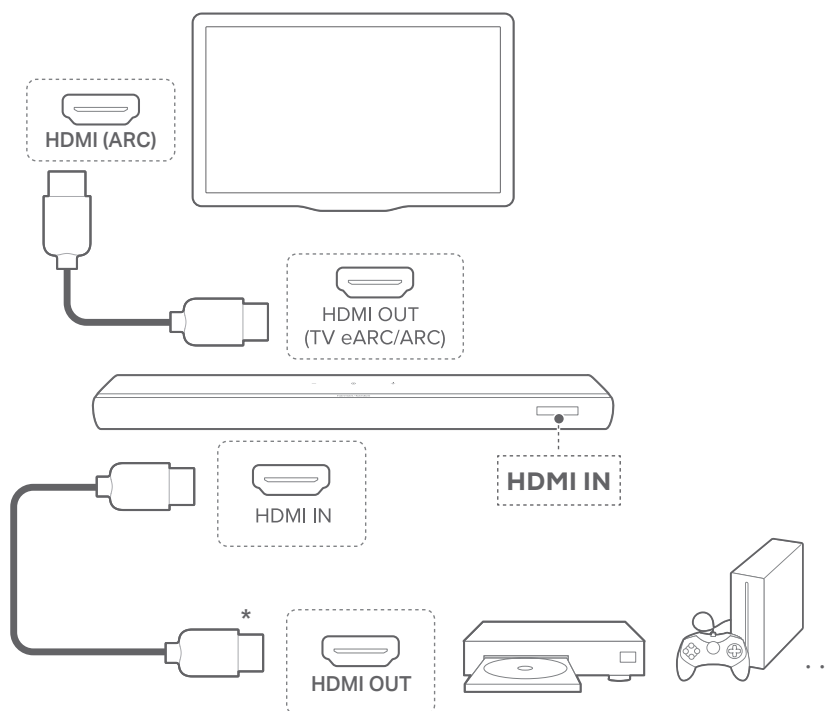

- 1) Make sure that the soundbar has been properly connected to your TV and digital device (See [“5.1 Connect with your TV and digital devices”](#)).

2) Switch on your digital device.

→ Your TV and the soundbar wake up from standby mode and switch to the input source automatically.

- To select the **HDMI IN** source on the soundbar, press **⏮** on the soundbar or **HDMI** on the remote control.

NOTE:

- Full compatibility with all HDMI-CEC devices is not guaranteed.

7.4 Play from the Bluetooth source

Through Bluetooth, stream audio play on your Bluetooth device to the soundbar.

- 1) Check that the soundbar has been properly connected to your Bluetooth device (See [“5.2 Connect to your Bluetooth device”](#)).
- 2) To select the Bluetooth source, press **⏮** on the soundbar or **📶** on the remote control.

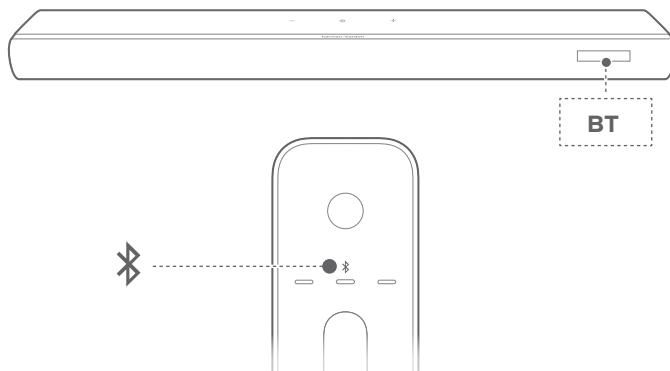

- 3) Start audio play on your Bluetooth device.
- Alternatively, press **PLAY/PAUSE** on the remote control to control playback.

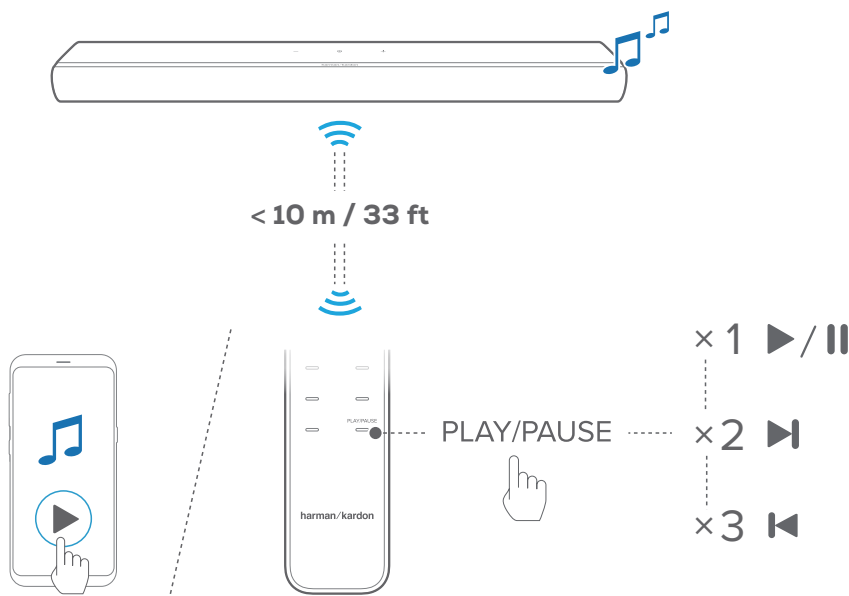

- 4) Adjust the volume on the soundbar, remote control or your Bluetooth device.

7.5 Play over your home network

NOTES:

- The soundbar can support audio streaming, but not video streaming.
- During Wi-Fi music streaming, music playback will pause on the currently connected device when you start music playback on a second connected device.
- When the soundbar switches between your home Wi-Fi and wired network during AirPlay, music playback will pause and resume in a few minutes, depending on broadband bandwidth conditions. For the connection to your home wired network, see [“5.3 Connect to your home network”](#).

Before you start, make sure that:

- your Android or iOS device is connected to the same Wi-Fi network as your soundbar (See [“5.3 Connect to your home network”](#)).

7.5.1 Play with Google Cast

With Google Cast, stream audio on your Android or iOS device to the soundbar.

On your Android or iOS device,

- 1) Launch the Harman Kardon One app, and check that you have enabled Google Cast.

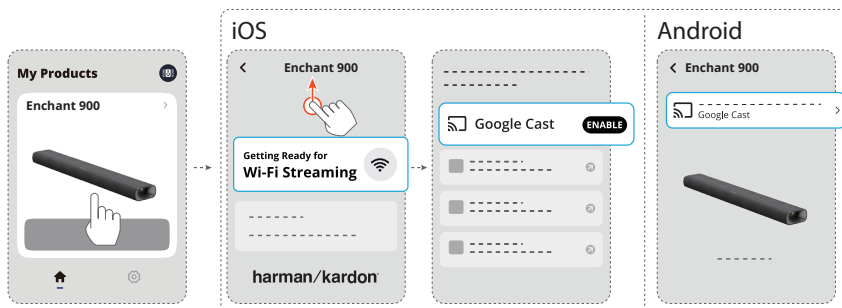

- 2) On a Google Cast-enabled app, play music, tap the cast icon  and select the connected soundbar.

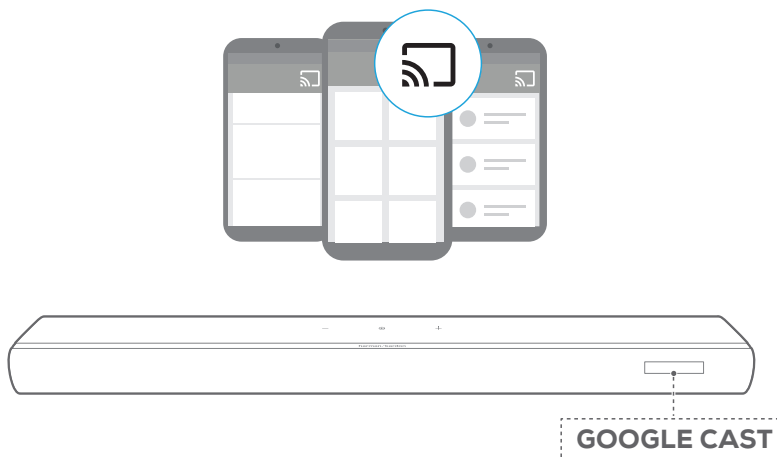

7.5.2 Play through AirPlay

Through AirPlay, stream audio on your iOS device to the soundbar.

On your iOS device:

- 1) Swipe down from the upper right corner to enter the Control Center.
- 2) Tap  to select the connected soundbar and then start audio streaming from an app.

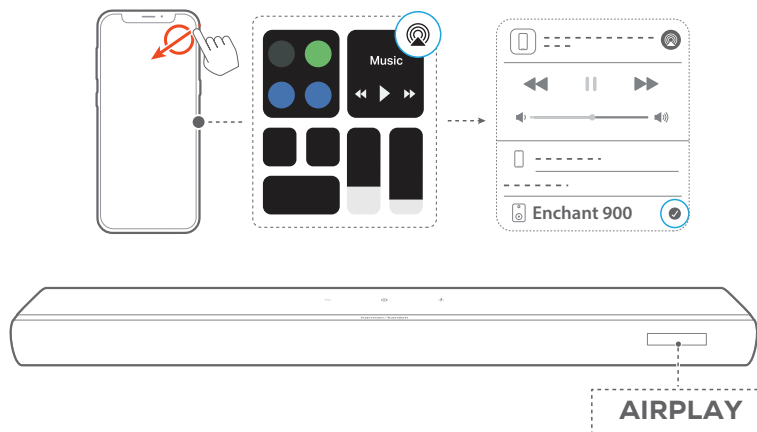

7.5.3 Play through the Harman Kardon One app

Through the Harman Kardon One app, stream audio from enabled music services to the soundbar.

On your Android or iOS device:

- Launch the Harman Kardon One app, browse the available *music streaming services to select music, and then start music streaming to the connected soundbar.

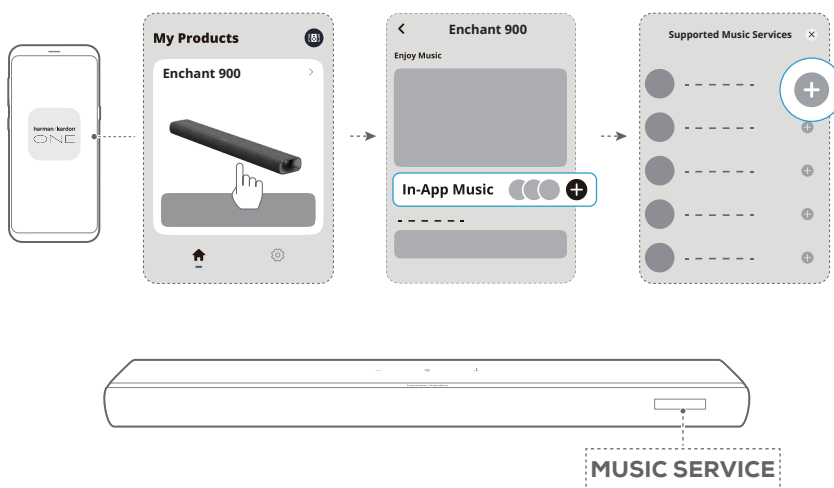

NOTE:

- *Subscription may be needed and not provided by the Harman Kardon One app.

7.5.4 Access your presets with the MOMENT button

- 1) On the Harman Kardon One app,
 - Personalize the **MOMENT** feature.

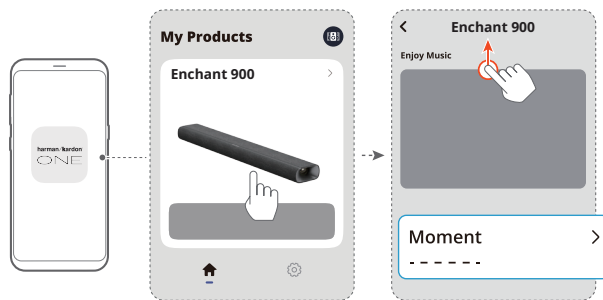

- 2) On the soundbar,
 - Press **MOMENT** on the remote control to access the personalized playlist and soundbar settings.

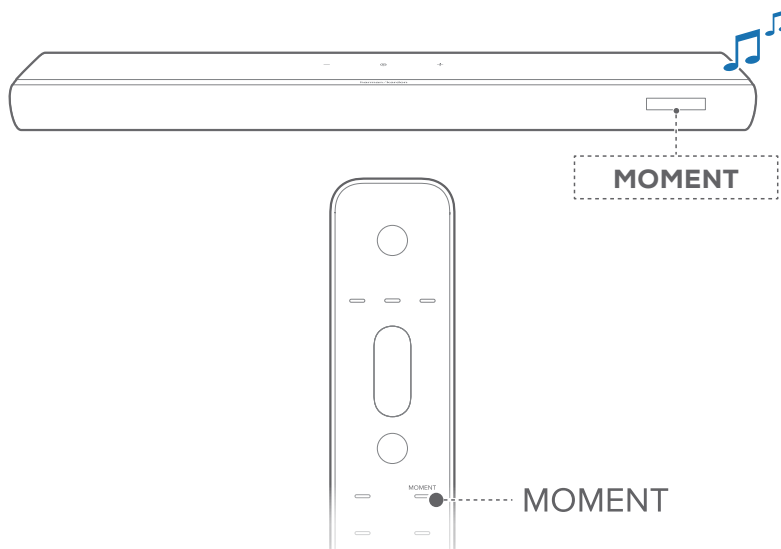

7.5.5 Multi-room playback

With the multi-room playback, you can stream music on your Android or iOS device to multiple Google Cast / AirPlay-enabled speakers.

Google Cast

- 1) Through the Google Home app, connect multiple Google Cast-enabled speakers to the same network, assign them to multiple rooms, and create groups as needed.
- 2) Run a Google Cast-enabled app on your smartphone or tablet.
- 3) Play music. Press  and select the grouped speakers.

NOTES:

- To create a multi-room speaker group in the Google Home app, make sure that you have connected all the speakers to the same home network and have used the same Google login account. Refer to the Google Home app for more details.
- Depending on the bandwidth of your local network, you can stream music to up to 6 Google Cast-enabled soundbars.

AirPlay

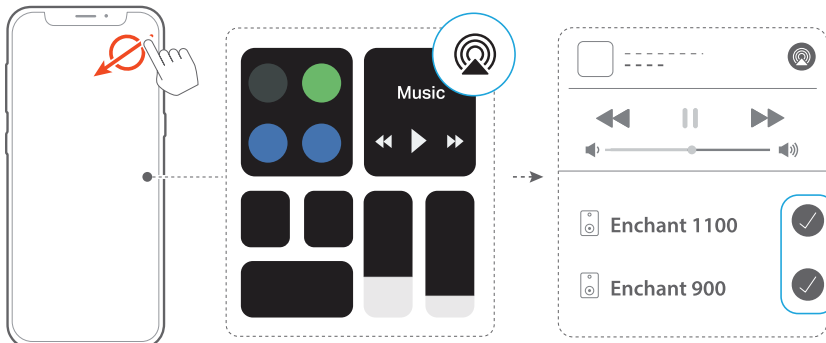

- 1) On an iOS device, enter the Control Center.
- 2) Tap  to select multiple connected speakers as needed.
- 3) Start music streaming from an app.

8 SOUND SETTINGS

8.1 Audio sync mode

With the audio sync function, you can synchronize audio and video to make sure that no delay is heard from your video content.

- 1) On the remote control, hold **TV** for more than 3 seconds and then press **+**.
→ “**SYNC**” is displayed.
- 2) Within 5 seconds, press **+** or **–** on the remote control to adjust the audio delay and match with video.
→ The audio sync timing is displayed.

NOTE:

- You can also adjust the audio delay through the Harman Kardon One app.

8.2 Smart mode

With Smart mode enabled by default, you can enjoy TV programs with rich sound effects. For TV programs such as news and weather forecasts, you can reduce the sound effects by disabling Smart mode and switching to Standard mode.

Smart mode: EQ settings and surround sound are applied for rich sound effects.

Standard mode: The preset EQ settings are applied for standard sound effects.

- When no rear speakers are connected to the soundbar, press **SURROUND** on the remote control to enable or disable the Smart mode.
→ “**OFF SMART MODE**”: The soundbar switches to the Standard mode. Next time you switch on the soundbar, the Smart mode is enabled again automatically.
→ “**ON SMART MODE**”: The Smart mode is enabled.

9 GROUPING (Optional)

Through the Harman Kardon One app, you can wirelessly pair your Enchant 900 with:

- Enchant Sub (subwoofer, sold separately): to enhance the bass performance;
- A pair of Enchant Speaker (satellite speakers, sold separately): to enhance the 3D surround sound experience;
- Enchant Sub and a pair of Enchant Speaker: to set up a 5.1.4 channel surround sound system.

When compatible Enchant devices are connected to the same network, follow the app instructions to group them.

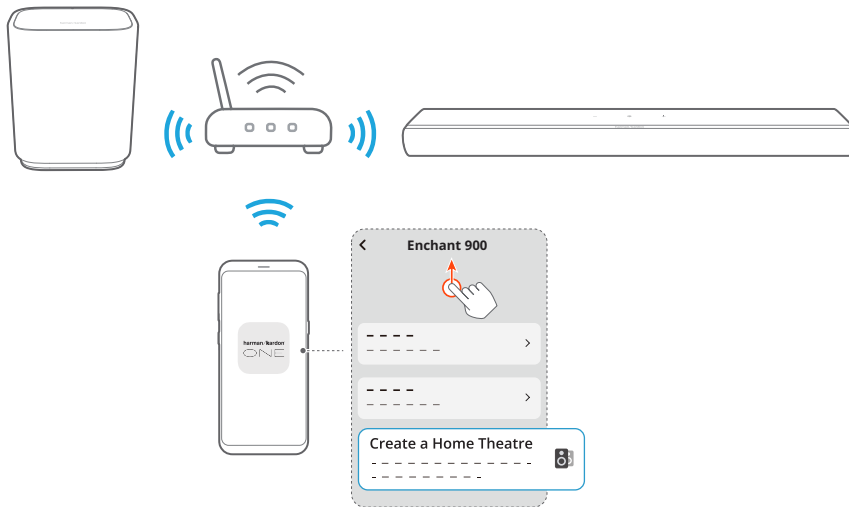

NOTE:

- In the Harman Kardon One app, you can rename or unpair the group.

10 RESTORE FACTORY SETTINGS

By restoring the factory default settings, you can remove all your personalized settings from the soundbar.

On the soundbar, hold **⏮**, **+** and **–** together for more than 5 seconds.

→ “RESET” is displayed.

→ The soundbar restarts.

11 SOFTWARE UPDATE

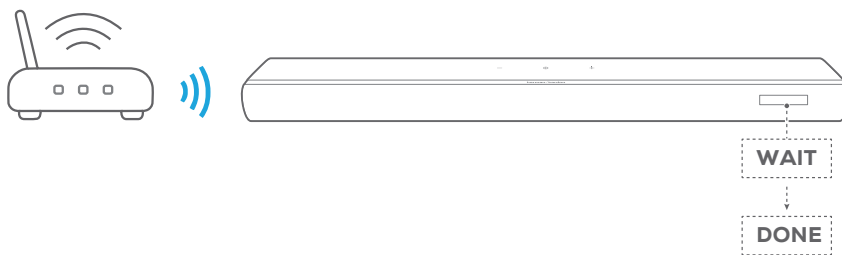

Connect the soundbar to your home network. Online updates will be performed automatically when software updates are available.

→ “**WAIT**”: Software updating in progress

→ “**DONE**”: Software updating completed

12 PRODUCT SPECIFICATIONS

General Specification

- Model: ENCHANT 900
- Power supply: 100 – 240 V AC, ~ 50/60 Hz
- Total speaker power output (RMS@THD 1%): 195 W
- Soundbar output power (RMS@THD 1%): 6 x 25 W woofer and full-range + 3 x 15 W tweeter
- Soundbar transducer: 4x (55 x 75) mm racetrack drivers, 3x 1" (25 mm) tweeters, 2x 2.5" (63 mm) up-firing full-range drivers
- Networked standby power: < 2.0 W
- Operating temperature: 0 °C – 45 °C

HDMI Specification

- HDMI video input: 1
- HDMI video output (with Enhanced Audio Return Channel, eARC): 1
- HDMI HDCP version: 2.3
- HDR pass through: HDR10, Dolby Vision

Audio Specification

- Frequency response: 60Hz - 20kHz (-6dB)
- Audio inputs: 1 Optical, Bluetooth and USB (USB playback is available in US version. For other versions, USB is for Service only.)

USB specification (Audio playback is for US version only)

- USB port: Type A
- USB rating: 5V DC, 0.5A
- Supporting file format: MP3
- MP3 codec: MPEG 1 Layer 2/3, MPEG 2 Layer 3, MPEG 2.5 Layer 3
- MP3 sampling rate: 16 - 48 kHz
- MP3 bitrate: 80 - 320 kpbs

Wireless specification

- Bluetooth version: 5.3
- Bluetooth profile: A2DP 1.3.2, AVRCP 1.5
- Bluetooth transmitter frequency range: 2400 MHz - 2483.5 MHz
- Bluetooth transmitter power: <15 dBm (EIRP)
- Wi-Fi network: IEEE 802.11 a/b/g/n/ac/ax (2.4GHz/5GHz)
- 2.4G Wi-Fi transmitter frequency range: 2412 - 2472 MHz (2.4 GHz ISM Band, USA 11 Channels, Europe and others 13 Channels)
- 2.4G Wi-Fi transmitter power: < 20 dBm (EIRP)
- 5G Wi-Fi transmitter frequency range: 5.15 - 5.35GHz, 5.470 - 5.725GHz, 5.725 - 5.825GHz
- 5G Wi-Fi transmitter power: 5.15 - 5.25GHz <23dBm (EIRP), 5.25 - 5.35GHz & 5.470 - 5.725GHz <20dBm (EIRP), 5.725 - 5.825GHz <14dBm (EIRP)

Note: Band 5.6 - 5.64 GHz will be disabled when shipped to Australia / New Zealand.

Dimensions

- Dimensions (W x H x D): 870 x 65 x 130 mm / 34.2" x 2.6" x 5.1"
- Weight: 3.5 kg / 7.7 lbs
- Packaging dimensions (W x H x D): 978 x 166 x 189 mm / 38.5" x 6.5" x 7.4"
- Packaging weight: 6.01 kg / 13.25 lbs

13 TROUBLESHOOTING

Never try to repair the product yourself. If you have problems using this product, check the following points before you request services.

System

The unit will not turn on.

- Check if the power cord is plugged into power and the soundbar.

The soundbar has no response to button presses.

- Restore the soundbar to factory settings (See [“10 RESTORE FACTORY SETTINGS”](#)).

Sound

No sound from soundbar

- Make sure that the soundbar is not muted.
- Select the correct audio input source on the remote control.
- Connect the soundbar to your TV or other devices properly.
- Restore the soundbar to its factory settings by holding **⊖**, **+** and **–** on the soundbar for more than 5 seconds.

Distorted sound or echo

- If you play audio from your TV through the soundbar, make sure that your TV is muted or the built-in TV soundbar is disabled.

Audio and video are not synchronized.

- Enable the audio sync function to synchronize audio and video (See [“8.1 Audio sync mode”](#)).

No height sound effects of Dolby Atmos

- If your TV supports HDMI ARC only, make sure that you have connected your digital device to the soundbar through the **HDMI IN** connector on the soundbar (See [“5.1 Connect with your TV and digital devices”](#))
- Enjoy the sound effects of Dolby Atmos when you play movies from the TV / HDMI source. For audio streaming over Bluetooth or casting apps (enabled by Google Cast or AirPlay), Dolby Atmos is not supported.

Bluetooth

A device cannot be connected with the soundbar.

- Check if you have enabled Bluetooth on the device.
- If the soundbar has been paired with another Bluetooth device, reset Bluetooth (See [“5.2.3 To connect to another Bluetooth device”](#)).
- If your Bluetooth device has ever been paired with the soundbar, reset Bluetooth on the soundbar, unpair the soundbar on the Bluetooth device, and then pair the Bluetooth device with the soundbar again (See [“5.2.3 To connect to another Bluetooth device”](#)).

Poor audio quality from a connected Bluetooth device

- The Bluetooth reception is poor. Move the source device closer to the soundbar, or remove any obstacle between the source device and the soundbar.

The connected Bluetooth device connects and disconnects constantly.

- The Bluetooth reception is poor. Move the source device closer to the soundbar, or remove any obstacle between the source device and the soundbar.

Wi-Fi

Failed to connect to Wi-Fi.

- Make sure that Wi-Fi is turned on.
- Make sure that you have selected the right network and entered the correct password.
- Make sure that your router or modem is turned on and within the range.
- In your router settings, make sure that you have set the security type to WPA2 or auto.
- Make sure that your soundbar is connected to the same wireless LAN as your smartphone or tablet.
- If you have difficulties in setting up Wi-Fi, hold **+** and **–** on the soundbar until **"SETUP WIFI"** is displayed.

Playback

AirPlay cannot find the soundbar as an AirPlay soundbar for music streaming.

- On your Apple device, update the software to the latest version: iOS 13.4 and later, macOS 10.15.4 and later, or tvOS 14.3.
- Make sure that your Apple device has been connected to the same network as the soundbar.
- For a PC running iTunes for Windows, you can stream music from your PC to the soundbar through Bluetooth.

Music playback does not work smoothly when the sound source switches from Bluetooth to Google Cast or AirPlay.

- The quality of audio casting and playback are dependent on the traffic and coverage of the network that connects the soundbar and your casting devices, such as phones, tablets and PCs.

Music playback does not resume when the sound source switches from Bluetooth to TV / HDMI IN, and then back to Bluetooth.

- The music playback in the Bluetooth device stops when the sound source switches from Bluetooth to TV / HDMI IN. When you switch back to the Bluetooth source, start music playback in the Bluetooth device again.

Remote control

The remote control does not work.

- Check if the batteries are drained. If so, replace them with new ones.
- Reduce the distance and angle between the remote control and the main unit.

Failed to complete the TV remote control learning.

- Check if you are using an infra-red TV remote control. The IR learning is not supported by a Bluetooth TV remote control.

14 TRADEMARKS



The Bluetooth® word mark and logos are registered trademarks owned by Bluetooth SIG, Inc. and any use of such marks by HARMAN International Industries, Incorporated is under license. Other trademarks and trade names are those of their respective owners.



The terms HDMI, HDMI High-Definition Multimedia Interface, HDMI trade dress and the HDMI Logos are trademarks or registered trademarks of HDMI Licensing Administrator, Inc.



Wi-Fi CERTIFIED 6™ and the Wi-Fi CERTIFIED 6™ Logo are trademarks of Wi-Fi Alliance®.



Dolby, Dolby Vision, Dolby Atmos, and the double-D symbol are registered trademarks of Dolby Laboratories Licensing Corporation. Manufactured under license from Dolby Laboratories. Confidential unpublished works. Copyright © 2012–2021 Dolby Laboratories. All rights reserved.



Google, Android, Google Home, Google Cast and other marks are trademarks of Google LLC. Google Assistant is not available in certain languages and countries. Availability and performance of certain features, services, and applications are device and network dependent and may not be available in all areas.



Use of the Works with Apple badge means that an accessory has been designed to work specifically with the technology identified in the badge and has been certified by the developer to meet Apple performance standards. Apple, and AirPlay are trademarks of Apple Inc., registered in the U.S. and other countries and regions. To use AirPlay with Harman Kardon Enchant 900, the latest version of iOS, iPadOS, or macOS is recommended.



Use your phone, tablet or computer as a remote control for Spotify. Go to spotify.com/connect to learn how.

The Spotify Software is subject to third party licenses found here: <https://www.spotify.com/connect/third-party-licenses>.

15 OPEN SOURCE LICENSE NOTICE

This product contains open source software licensed under GPL. For your convenience, the source code and relevant build instruction are also available at

https://harman-webpages.s3.amazonaws.com/Harman_One_OS_C_package_license_list.htm

Please feel free to contact us at:

Harman Deutschland GmbH

ATT: Open Source, Gregor Krapf-Gunther, Parkring 3

85748 Garching bei Munchen, Germany

or OpenSourceSupport@Harman.com if you have additional question regarding the open source software in the product.

harman/kardon®
by HARMAN